



NEED HELP? rebelgutterguards.com/installation



DO NOT RETURN PRODUCT TO THE STORE!!!
 IF YOU NEED FURTHER ASSISTANCE, VISIT OUR WEBSITE AT WWW.REBELGUTTERGUARDS.COM FOR MORE PICTURES, TIPS AND FREQUENTLY ASKED QUESTIONS.

GUTTER GUARD SAFETY



WHEN INSTALLING GUTTER GUARDS, ALWAYS MAKE SAFETY YOUR TOP PRIORITY, USE YOUR LADDER, TOOLS AND EQUIPMENT CORRECTLY.

WE PRIORITIZE YOUR SAFETY

(VERIFY BEFORE INSTALL)

LOCAL BUILDING CODES FOR YOUR AREA

CHECK IF SHINGLES ARE ADHERED TO THE UNDERLAYMENT

REMOVE ANY LABELS OR STICKERS



FREEZING CONDITIONS

IF FREEZING IS COMMONPLACE FOR YOUR AREA THE FOLLOWING ISSUES MAY OCCUR

ICE DAMS
 A RIDGE OF ICE THAT FORMS AT THE EDGE OF A ROOF AND PREVENTS MELTING SNOW (WATER) FROM DRAINING OFF THE ROOF

ICICLES
 A HANGING, TAPERING PIECE OF ICE FORMED BY THE FREEZING OF DRIPPING WATER.



SCAN TO BE DIRECTED TO REBELGUTTERGUARDS.COM WARRANTY INFO, POPULAR QUESTIONS, AND INSTALLATION HELP



INCLUDED

3FT SECTIONS x 13

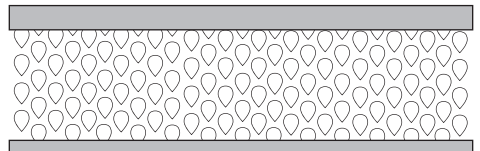

1x BAG OF SELF TAPPING SCREWS

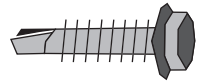

1x MAGNETIC NUT SETTER

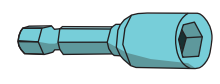

RECOMMENDED TOOLS

WORKING GLOVES



AVIATION SNIPS



EXTENSION LADDER

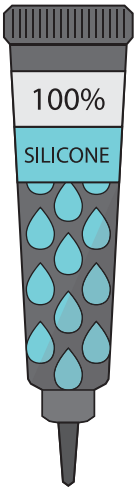

SAFETY GLASSES



TAPE MEASURE

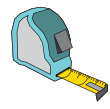

ELECTRIC DRILL



Basic Installation Guidelines

Clean Gutters thoroughly before installation

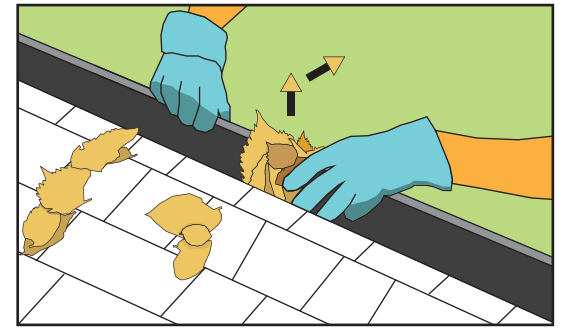

Try to keep gutter guard at the same pitch angle as the roof

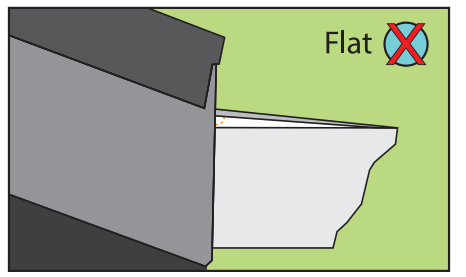
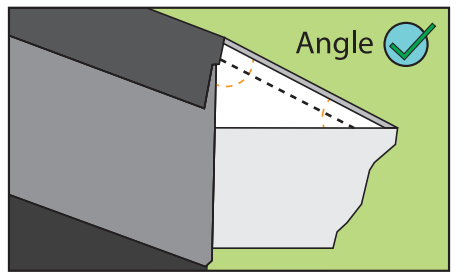

DO NOT INSTALL with the gutter guard flat to avoid debris build up

(RECOMMENDED)
INSTALL THE INSIDE AND OUTSIDE CORNERS
FIRST, THEN FILLING IN THE STRAIGHT
SECTIONS IN BETWEEN

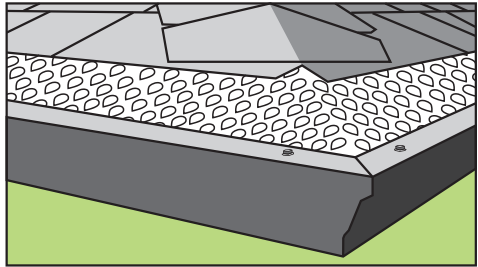

INSIDE MITER

LINE UP TWO HALVES OF
GUTTER GUARD MAKING
NOTE OF WHERE
THEY OVERLAP

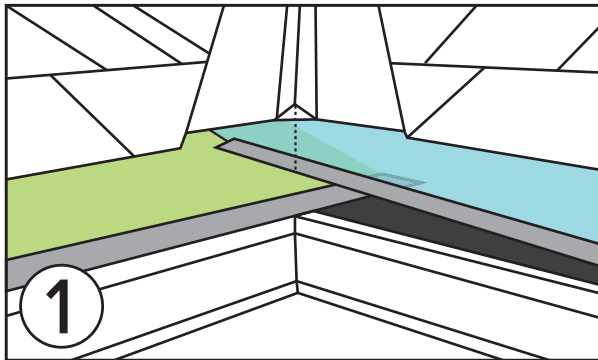

CUT AND REMOVE THE RAIL
THAT OVERLAPS AND LAYER THE
MESH OVER ONE ANOTHER

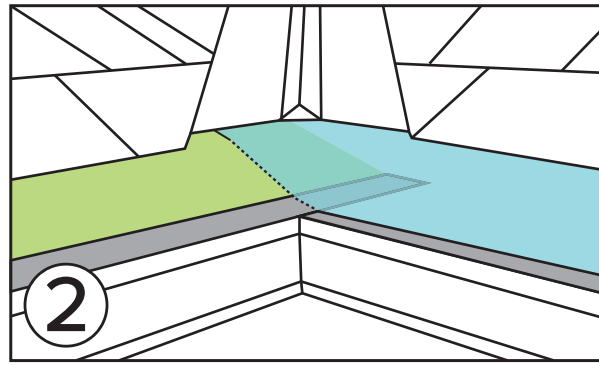
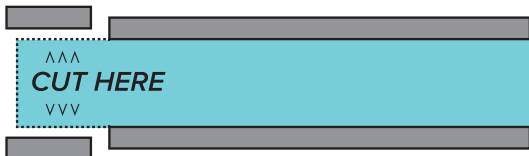

OVERLAP SECTIONS OF GUTTER
GUARD THEN FASTEN DOWN TO
THE GUTTER FRAME

OUTSIDE MITER

LINE UP TWO HALVES OF
GUTTER GUARD MAKING
NOTE OF WHERE
THEY OVERLAP

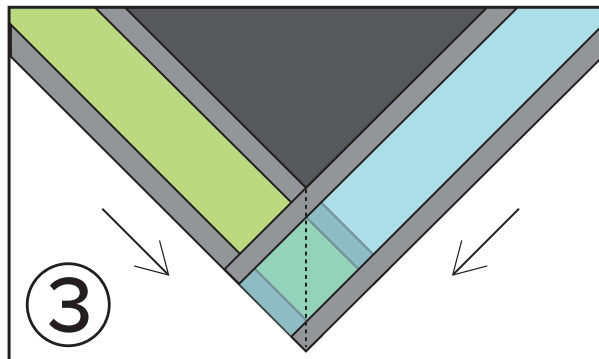

USE AVIATION SNIPS TO CUT
ALONG OVERLAPPED AREA
LEAVING A SMALL AMOUNT OF
MESH TO LAYER OVER THE TOP

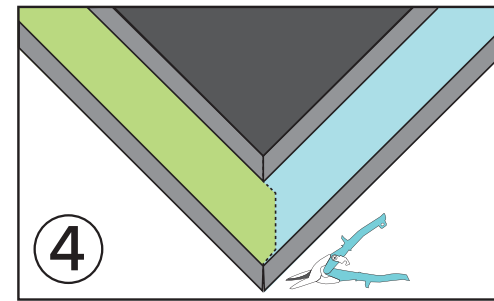

FASTEN TO THE GUTTER
WITH INCLUDED SELF
TAPPING SCREWS

UNDER THE SHINGLE INSTALLATION

INSERT GUTTER GUARD BETWEEN
THE SHINGLES AND
THE MOISTURE
BARRIER

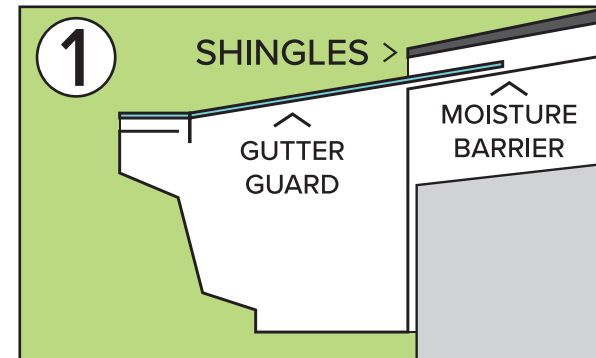

FASTEN THE GUARD WITH THE
INCLUDED SELF TAPPING SCREWS
TO THE GUTTER

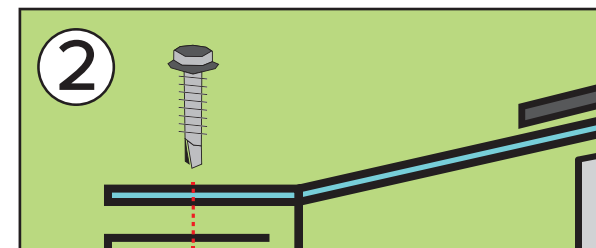

FASCIA INSTALLATION METHOD

MEASURE THE RAIN GUTTER OPENING
FROM THE FASCIA TO THE INSIDE
EDGE OF THE RAIN GUTTER'S FRONT
INSIDE LIP

MAKE THE MEASUREMENT 1/8 LESS
THAN THE ACTUAL LENGTH MEAS-
URED (MEASURE ON THE GUTTER
GUARD FROM THE "FRONT RAIL STOP"
TOWARDS THE BACK RAIL)

BEND THE FASCIA SIDE TO 90
DEGREES USING PLIERS OR OTHER
METHODS AND FASTEN TO THE
FASCIA

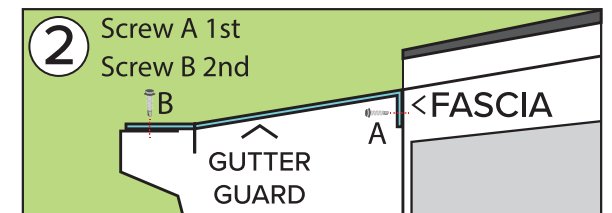
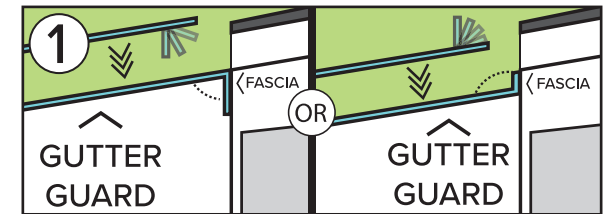

TO FINISH TRIM AND CUT MESH
AND BEND TO 90 DEGREES MAKE
A END CAP FILL GAPS
WITH 100% SILICONE

